

MERILO

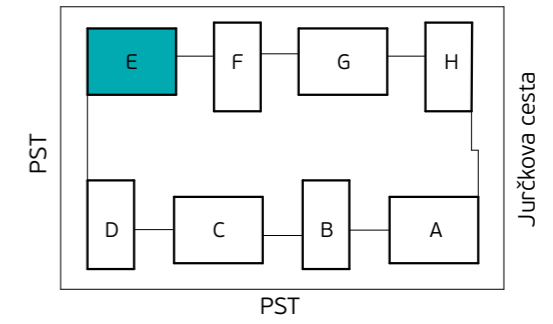

Skica naselja

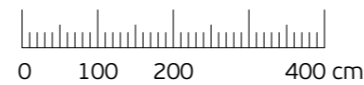
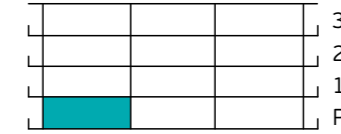

Položaj stanovanja v stavbi - prerez

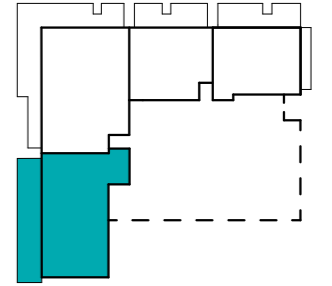

Položaj stanovanja v nadstropju - tloris

STAVBA "E" - PRITLIČJE

## STANOVANJE E-0-1

|                    |                     |
|--------------------|---------------------|
| 1. PREDPROSTOR     | 5.9 m <sup>2</sup>  |
| 2. BIVALNI PROSTOR | 57.0 m <sup>2</sup> |
| 3. SPALNICA        | 19.0 m <sup>2</sup> |
| 4. KABINET 1       | 10.6 m <sup>2</sup> |
| 5. KABINET 2       | 10.9 m <sup>2</sup> |
| 6. KOPALNICA 1     | 4.2 m <sup>2</sup>  |
| 7. KOPALNICA 2     | 4.5 m <sup>2</sup>  |
| 8. WC IN UTILITY   | 3.1 m <sup>2</sup>  |
| 9. SHRAMBA         | 3.2 m <sup>2</sup>  |

**STANOVANJSKA POVRŠINA 118.4 m<sup>2</sup>**

|                       |                     |
|-----------------------|---------------------|
| 10. TERASA (NADKRITA) | 20.5 m <sup>2</sup> |
| 10. TERASA            | 20.6 m <sup>2</sup> |
| 11. SHRAMBA ZA KOLESA | 8.8 m <sup>2</sup>  |

**SKUPNA POVRŠINA 168.3 m<sup>2</sup>**

PARKIRNO MESTO 2 PM

VISEČI VRTOVI 10.1 m<sup>2</sup>



**PRVAHIŠA**

Družba za razvoj nepremičninskih projektov

INVESTITOR: **JURČKOVO NASELJE d.o.o.**

PRODAJALEC: **PRVA HIŠA d.o.o.**

Bravničarjeva ulica 13, 1000 Ljubljana

+386 (0)1 292 65 00

info@prvahisa.si

www.jurckovo-naselje.si